

arch.kit.edu

**FAKULTÄT
FÜR ARCHITEKTUR**

Welcome to the Department of Architecture



Welcome to the KIT-Department of Architecture



**FAKULTÄT
FÜR ARCHITEKTUR**

The KIT-Department of Architecture at the Karlsruhe Institute of Technology warmly welcomes you.

The lecture period will start on April 15th, 2024.

During the semester we will have numerous events that characterize life at our department. You will always find the announcement of the events on our homepage.

We wish you a good start.



Table of Contents



**FAKULTÄT
FÜR ARCHITEKTUR**

The Department

- Where are we located on Campus?
- Facts und Figures
- Organisation of the Department –
 - Institutes, Units
 - Professors
- Events /Social Media
- Impressions
- Information Resources
- Central Services
- Student Council
- Research

Introduction Master's Program

- Time table
- Study Structure
- Information Resources
- Campus Management
- When do I choose my courses?
- Where can I go, if I have problems with my courses
- How do I get my Transcript of Records before I go back to my home university?

Department tour –

To be organized with your Buddy or within O-Phase

„Virtual Tour“ on Homepage

<https://www.arch.kit.edu/fakultaet/einrichtungen.php>

Karlsruhe Institute of Technology (KIT)



**FAKULTÄT
FÜR ARCHITEKTUR**

The KIT

Section I - Biology, Chemistry and Process Engineering

Section II - Informatics, Economy and Society

Section III - Engineering and Electrical Engineering

Section IV - **Natural and Built Environment**

Section V - Physics and Mathematics

https://www.int.kit.edu/img/content/stadt_mit_schloss_luftbild_rdax_1200x674.jpg



Karlsruhe Institute of Technology (KIT)



**FAKULTÄT
FÜR ARCHITEKTUR**

Where are we located?

20.40 Architecture Building

11.40 Collegiate Building at the Ehrenhof

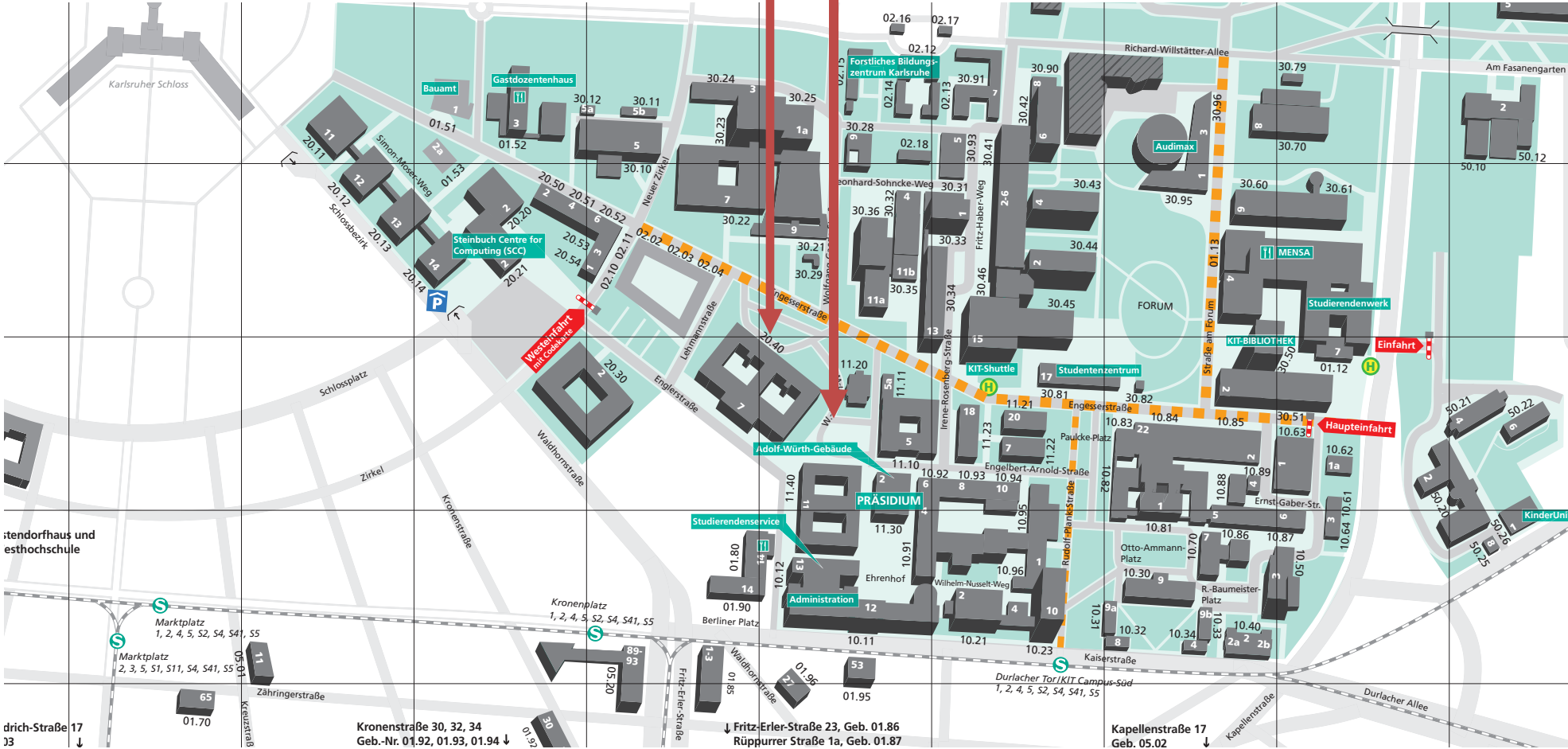

Department of Architecture



**FAKULTÄT
FÜR ARCHITEKTUR**

History

The Department of Architecture at the Karlsruhe Institute of Technology – the KIT, looks back onto a long tradition, which reaches back to the founding of the university of Karlsruhe in the year 1825.

Today

With 1,000 students, 100 scientists and 23 professors, the Department of Architecture at the KIT of Karlsruhe is pursuing a research-oriented teaching approach in cooperation with public organizations and companies - embedded in the excellent living and research environment of the greater Karlsruhe area.

Our central task is to sustainably improve teaching and research in our field and to develop strategies for the transformation of our built environment.



Department of Architecture



**FAKULTÄT
FÜR ARCHITEKTUR**

Mission

Architectural design (Entwerfen) is the core of the Department and the exploration of complex aesthetic and spatial solutions with a sustainable aim its primary objective.

Design (Entwerfen) forms a strong intellectual culture. Within this culture the ability to synthesize is a key competence – a unique skill that is much needed in society to solve the pressing issues of the future.

An integrated approach is what KIT Architecture offers at many levels. The common theme of the Department, which also encompasses landscape and urban architecture, cultural tradition and technology, is the exploration of design strategies for built environment and the big challenges of future.

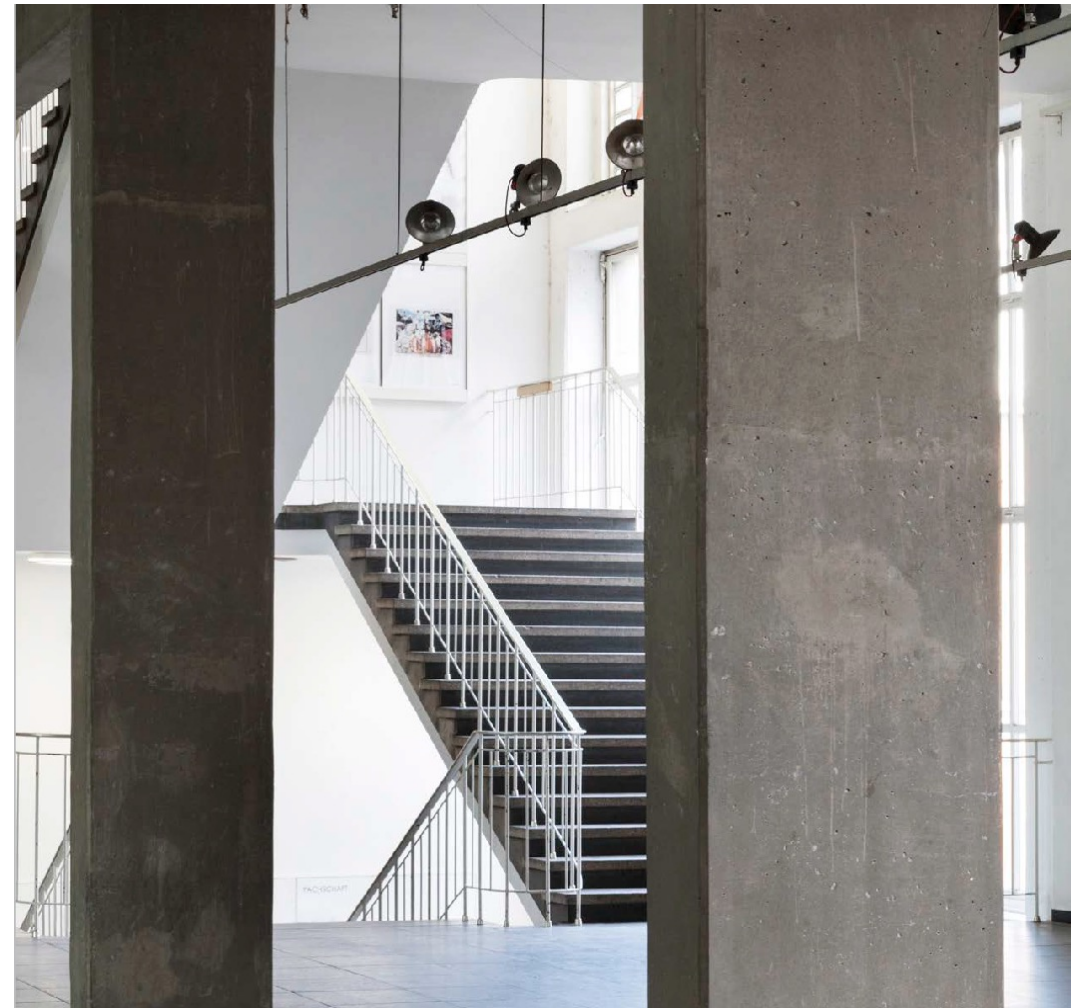

Vision

The Department gives young architects the broad expertise to enable them to develop future strategies for the spatial and material evolution of society.

We believe in engaging positively with the ongoing challenges of globalization, cultural transformations and climate change.

Our vision is to play a crucial role in the global efforts to incorporate design strategies into research to deliver resilient solutions to systemic challenges.



Department of Architecture



**FAKULTÄT
FÜR ARCHITEKTUR**

Facts and Figures

- 4** Institutes
- 23** Units (Specialist- and subject area)
- 2** Guest Professors
- 60** Ass. Professors
- 70** Doctoral students
- 1000** Students – **850** Architecture Students
- 150** International Students

Courses offered at the Department

- Bachelor / Master Architecture
- Bachelor / Master History of Art
- French-German Double Masterprogramme „Building and Planning in Euroregions“ in Cooperation with the ENSA Strasbourg (France)

Department of Architecture

The Institutes



**FAKULTÄT
FÜR ARCHITEKTUR**

Institute for Architectural Design, Art and Theory (EKUT)

- Spatial Design
- Building Design
- Architectural Design
- Visual Arts
- Theory of Architecture
- Communication of Architecture

Institute for Building Design and Technology (IEB)

- Building Construction
- Building Construction Methodology
- Sustainable Building
- Building Lifecycle Management
- Structural Design
- Building Materials and Components
- Building Technology
- Building Science and Technical Installation

Institute for Urban and Landscape Design (IESL)

- Urban Housing and Development
- International Urban Design
- Landscape Architecture
- Urban Living

Institute for History of Art and Architecture (IKB)

- Art History
- History of Building and Architecture

Department of Architecture The Institutes – EKUT

arch.kit.edu

**FAKULTÄT
FÜR ARCHITEKTUR**

**Institut
Entwerfen,
Kunst und
Theorie
(EKUT)**



Prof. Marc Frohn

RAUM UND ENTWERFEN
Spatial Design



Prof. Meinrad Morger

GEBÄUDELEHRE
Building Design



Prof. Simon Hartmann

BAUPLANUNG UND
ENTWERFEN
Architectural Design



Prof. Stephen Craig

BILDENDE KUNST
Visual Arts



**Prof. Dr. Anna-Maria
Meister**

ARCHITEKTURTHEORIE
Theory of Architecture



Prof. Dr. Riklef Rambow

ARCHITEKTUR-
KOMMUNIKATION
Communication of
Architecture

Department of Architecture The Institutes – EKUT



**FAKULTÄT
FÜR ARCHITEKTUR**

**Institut
Entwerfen,
Kunst und
Theorie
(EKUT)**



Prof. Marc Frohn
RAUMGESTALTUNG
UND ENTWERFEN
Spatial Design

Architectural Office:

FAR frohn & rojas
Berlin, Santiago de Chile,
Los Angeles

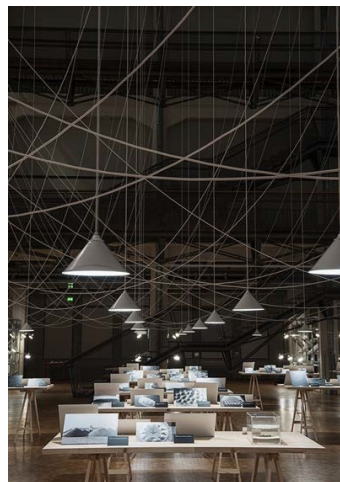

Prof. Meinrad Morger
GEBÄUDELEHRE
Building Design

Architectural Office:

Morger & Partner
Basel, Switzerland



Department of Architecture The Institutes – IEB



**FAKULTÄT
FÜR ARCHITEKTUR**

**Institut
Entwerfen
und Bau-
technik
(IEB)**



Prof. Ludwig Wappner
BAUKONSTRUKTION
Building Construction



Prof. Andrea Klinge
KONSTRUIEREN UND
ENTWERFEN
Construction and Design



Prof. Dirk Hebel
NACHHALTIGES BAUEN
Sustainable Construction



Prof. Dr. Petra v. Both
BUILDING LIFECYCLE
MANAGEMENT
Building Lifecycle Management



**Prof. Dr. Riccardo
La Magna**
TRAGWERKSPLANUNG
UND KONSTRUKTIVES
ENTWERFEN
Design of Structure



**Prof. Dr. Rosemarie
Wagner**
BAUTECHNOLOGIE
Building Technology



Prof. Andreas Wagner
BUILDING SCIENCE AND
TECHNOLOGY
Building Science



**Tenure-Track-Prof.
Moritz Dörstelmann**
DIGITAL DESIGN AND
FABRICATION
Digital Design and Fabrication

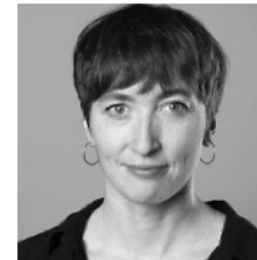

Prof. Dr. Caroline Karmann
ARCHITECTURE AND
INTELLIGENT LIVING
Architecture and Intelligent Living



Prof. Dr. Peter Schossig
TECHNOLOGIEN FÜR KLIMAGE-
RECHTE GEBÄUDE UND QUARTIERE
Technologies for Climate-Friendly
Buildings and Urban Districts

Neu

Department of Architecture The Institutes – IEB



**FAKULTÄT
FÜR ARCHITEKTUR**

**Institut
Entwerfen
und Bau-
technik
(IEB)**



Prof. Ludwig Wappner

BAUKONSTRUKTION
Building Construction

Architectural Office:

Allmann, Sattler, Wappner
München, Germany



Prof. Dirk Hebel

NACHHALTIGES BAUEN
Sustainable Building Design

Architectural Office:

Instant Architecture
Freiburg, Germany



Department of Architecture The Institutes – IESL



**FAKULTÄT
FÜR ARCHITEKTUR**

**Institut
Entwerfen
von Stadt und
Landschaft
(IESL)**



Prof. Markus Neppi
STADTQUARTIERSPLANUNG
Urban Housing and Development



Prof.'in Dr. Barbara Engel
INTERNATIONALER
STÄDTEBAU
International Urban Design



Prof. i.V. Sebastian Multerer
STADT UND WOHNEN
City and Housing



Prof. Christian Inderbitzin
STADT UND WOHNEN
City and Housing



Prof. Henri Bava
LANDSCHAFTS-
ARCHITEKTUR
Landscape Architecture

Department of Architecture The Institutes – IESL



**FAKULTÄT
FÜR ARCHITEKTUR**

**Institut
Entwerfen
von Stadt und
Landschaft
(IESL)**



Prof. Markus Neppi
STADTQUARTIERS-
PLANUNG
Urban Housing and
Development

Architectural Office:
ASTOC
Köln, Germany



**Prof. Christian
Inderbitzin**
Stadt und Wohnen
City and Housing

Architectural Office:
EMI Architekten
Zürich, Switzerland



Aabach
Studienauftrag
N°154

Waldhaus
Wettbewerb 4. Preis
N°153

Forel
Testplanung
N°152

Bell
Studienauftrag
N°151



Wolff
Studienauftrag 1. Preis
N°150

Zahnmedizin
Wettbewerb 3. Preis
N°149

Hochhaus
Studienauftrag
N°148

Bellevue
Studienauftrag
N°147



Harsplen
Wettbewerb
N°146

Maag
Studienauftrag
N°145

Flüela
Wettbewerb 1. Preis
N°144

Theater Winterthur
Planerwahlverfahren
N°143

Department of Architecture The Institutes – IKB

arch.kit.edu

FAKULTÄT
FÜR ARCHITEKTUR

Institut
Kunst-
und Bau-
geschichte
(IKB)



Prof. Dr. Oliver Jehle
KUNSTGESCHICHTE
Art History



**Prof.'in Dr. Inge
Hinterwaldner**
KUNSTGESCHICHTE
Art History



Prof. Dr. Joaquín Medina Warmburg
BAU- UND ARCHITEKTUR-
GESCHICHTE
History of Building and Architecture



**Gast-Prof.'in
Dr. Linda Báez Rubí**
KUNSTGESCHICHTE
Art History

Department of Architecture Guest-Professorship



**FAKULTÄT
FÜR ARCHITEKTUR**

**Gast-
professuren**
Sommer 2024



Christian Weyell / Kai Zipse

GASTPROFESSUR DER
WÜSTENROT STIFTUNG



Kerstin Müller

GASTPROFESSUR
ZIRKULÄRES BAUEN
Circular Construction

<http://www.arch.kit.edu/aktuelles/index.php>

Karlsruher Architekturvorträge SKIZZENWERK: Italien



SKIZZENWERK is a series of lectures organised by architecture students at the Karlsruhe Institute of Technology (KIT). Every summer semester, selected architecture and urban planning firms are invited to give a lecture on a current topic in order to stimulate discourse. To mark the 10th anniversary of SKIZZENWERK, the students are organising a series of country-specific lectures. The question arises as to which aspects characterise architecture in the different regions? On what scale do interventions take place? Which contemporary, constructive and socio-political issues, which problems and interests go hand in hand with the practice and characterise it? The lectures will take place on Wednesdays at 7 pm in the Egon Eiermann lecture theatre, Englerstraße 7, Building 20.40 in Karlsruhe.

Events



**FAKULTÄT
FÜR ARCHITEKTUR**

<http://www.arch.kit.edu/aktuelles/index.php>

Karlsruher Architekturvorträge SKIZZENWERK: Italien

The following speakers have been requested:

Parasite 2.0

<https://parasiteparasite.com/>

Enrico Dusi Studio

<http://www.enricodusi.com/>

Maria Giuseppina Grassa Cannizzo

Lecture about Stefania Filo Speciale

https://www.openhouseitalia.org/ast_filospeziale/

Domus (speaker Gulia Ricci or Bianca Felicori)

<https://www.domusweb.it/en.htm>

Events

<http://www.arch.kit.edu/aktuelles/index.php>



**FAKULTÄT
FÜR ARCHITEKTUR**

Weitere Veranstaltungen:

Ausstellung der Masterthesen

Gebäude 20.40, Foyers

08. – 17.04.2024

Mo–Fr, 9–19 Uhr

Feierliche Verabschiedung der Masterabsolvent:innen

Mi., 17.04., 18 Uhr, Fritz-Haller-Hörsaal

Vortrag von Mark Pimlott, TU Delft

Eingeladen von Simon Hartmann und

Alessandro Gess

Mi., 24.04.2024, 19 Uhr, Fritz-Haller-Hörsaal

10. Doktorand:innenkolloquium der KIT- Fakultät für Architektur

Mi., 08.05.2024, 14 bis 17:30 Uhr, Grüne Grotte

Verleihung des Hermann-Billing-Preis 2024

Mi., 08.05.2024, 18:00 Uhr,

Egon-Eiermann-Hörsaal

Campustag / Reinschauen

Informationsveranstaltung und Jahresausstellung

Egon-Eiermann-Hörsaal und alle Foyers 20.40

Sa., 8.06.2024, 11–16 Uhr

Antrittsvorlesung Dr. Anna-Maria Meister

Professur Architekturtheorie

Mi., 10.07., 19 Uhr, Fritz-Haller-Hörsaal

Abschiedsvorlesung Meinrad Morger

Professur Gebäudelehre

Mi., 17.07.2024, 19 Uhr, Fritz-Haller-Hörsaal

Bachelorverabschiedung und Sommerfest der Fakultät

Do., 01. August

Events



**FAKULTÄT
FÜR ARCHITEKTUR**

<http://www.arch.kit.edu/aktuelles/index.php>

Wie bauen wir in Zukunft?

Öffentliche Führungen zum Gebäudeprototyp
RoofKIT

Termine im Sommersemester 2024:

12. April 2024, 10. Mai 2024, 14. Juni 2024, 12. Juli
2024 um 14.30 Uhr

KIT Campus Süd RoofKIT (Geb. 30.79),
Anmeldung über die Webseite der Fakultät
erforderlich

Hochsitzcafé auf der Katzenwedelwiese

Sonntag, 21.4.2024 ab 11:00 Uhr

Katzenwedelwiese in Beiertheim-Bulach,
St. Florian Straße 14
76135 Karlsruhe

AT goes A SF

Dienstag, 09.07.2024, 17:00 – 20:00h

Architekturschaufenster

Waldstraße 8, 76131 Karlsruhe

Digitales nachhaltiges Bauen

**Neuinterpretation natürlicher Baustoffe
mittels digitaler Bautechnologien**

11.06.–30.08.2024

Architekturschaufenster

Waldstraße 8, 76133 Karlsruhe

Events



**FAKULTÄT
FÜR ARCHITEKTUR**

<http://www.arch.kit.edu/aktuelles/index.php>

Reinschauen

Annual Exhibition / Open Doors of the Department
as part of the CampusDay of KIT

Next Date: 8th of June 2024



Impressions

arch.kit.edu

**FAKULTÄT
FÜR ARCHITEKTUR**

Annual exhibition „Reinschauen“ in June



Impressions

arch.kit.edu

FAKULTÄT
FÜR ARCHITEKTUR

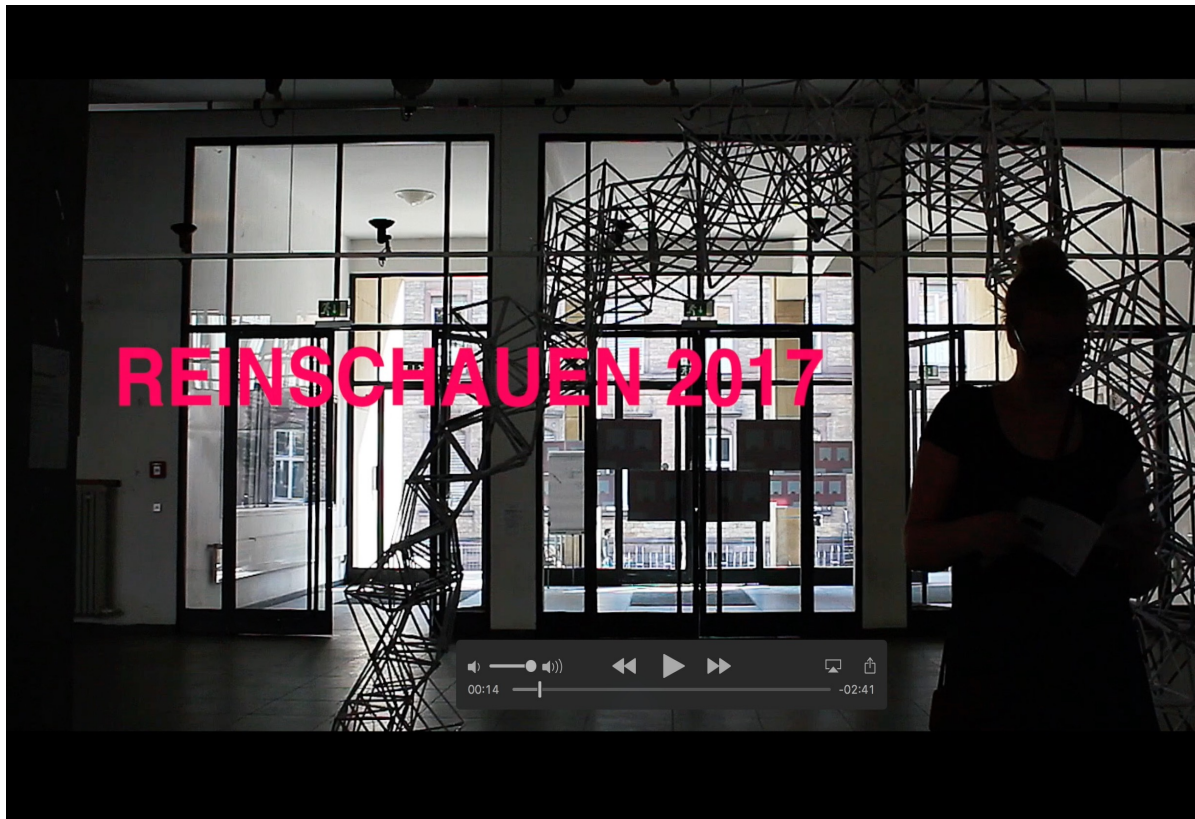

<https://www.youtube.com/watch?v=2Z5VP7b6CeI>

Social Media

http://www.arch.kit.edu/fakultaet/in_verbindung_bleiben.php



**FAKULTÄT
FÜR ARCHITEKTUR**

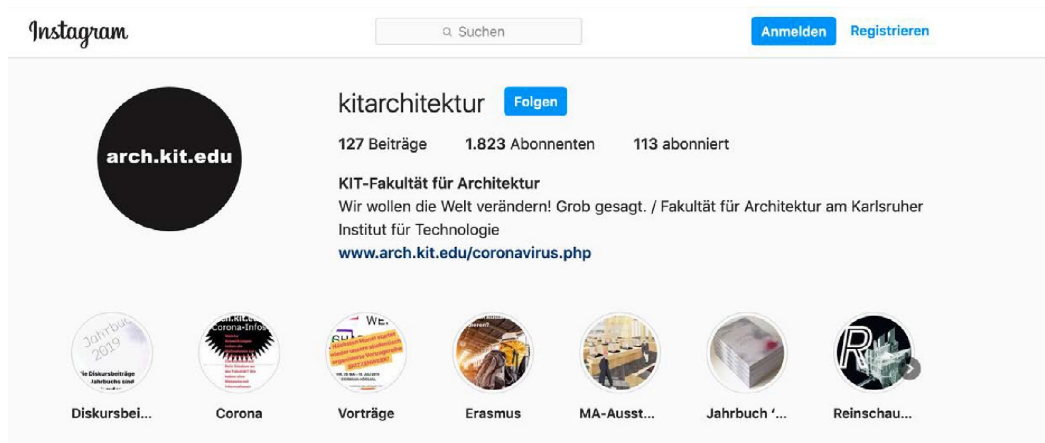

Facebook Page of the Department

<https://www.facebook.com/KIT.Architektur/>

Facebook Group of the Department

<https://www.facebook.com/groups/arch.kit.edu/>

Facebook Page of the Fachschaft

<https://www.facebook.com/FachschaftArchitekturKIT/>

Instagram

<https://www.instagram.com/kitarchitektur/>

Department of Architecture Publications



**FAKULTÄT
FÜR ARCHITEKTUR**

Online-Publications - BA / MA Thesis

<http://www.arch.kit.edu/aktuelles/abschlussarbeiten.php>

<https://open.arch.kit.edu>

open.arch.kit.edu



Jahrbuch



Department of Architecture Central Services



**FAKULTÄT
FÜR ARCHITEKTUR**

Faculty Library

20.40 Room 106



Library Architecture- and Art History

20.40 Room 016



Central Services

Wood Workshop

20.40 Room -149

Ms. Knipper

[more...](#)



Model Workshop

20.40 Room -152

Mr. Gäng

[more...](#)



Central Services

Photo Workshop

20.40 Room -102

Mr. Seeland / Mr. Engel



Metal Workshop

20.40 Room -115

more... Mr. Heil

more...



Central Services

archIT

11.40 Room 009–011
Mr. Besser / Mr. Gonzales

Building 20.40

PlotPool
Second Floor Room 262

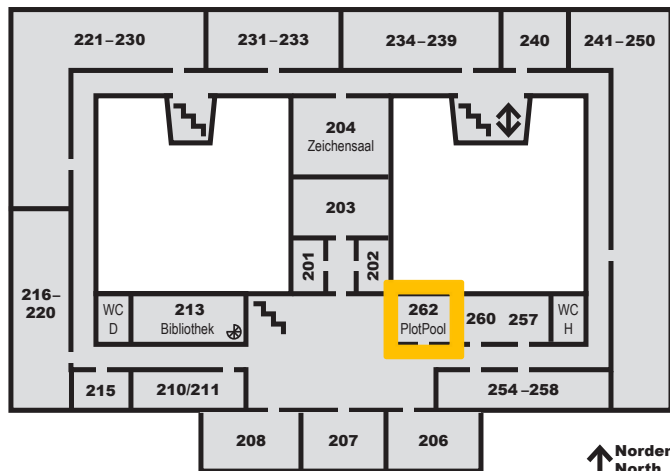

Digital Workshop

11.40 Room S 105–108 more...
Mr. Jager

more...

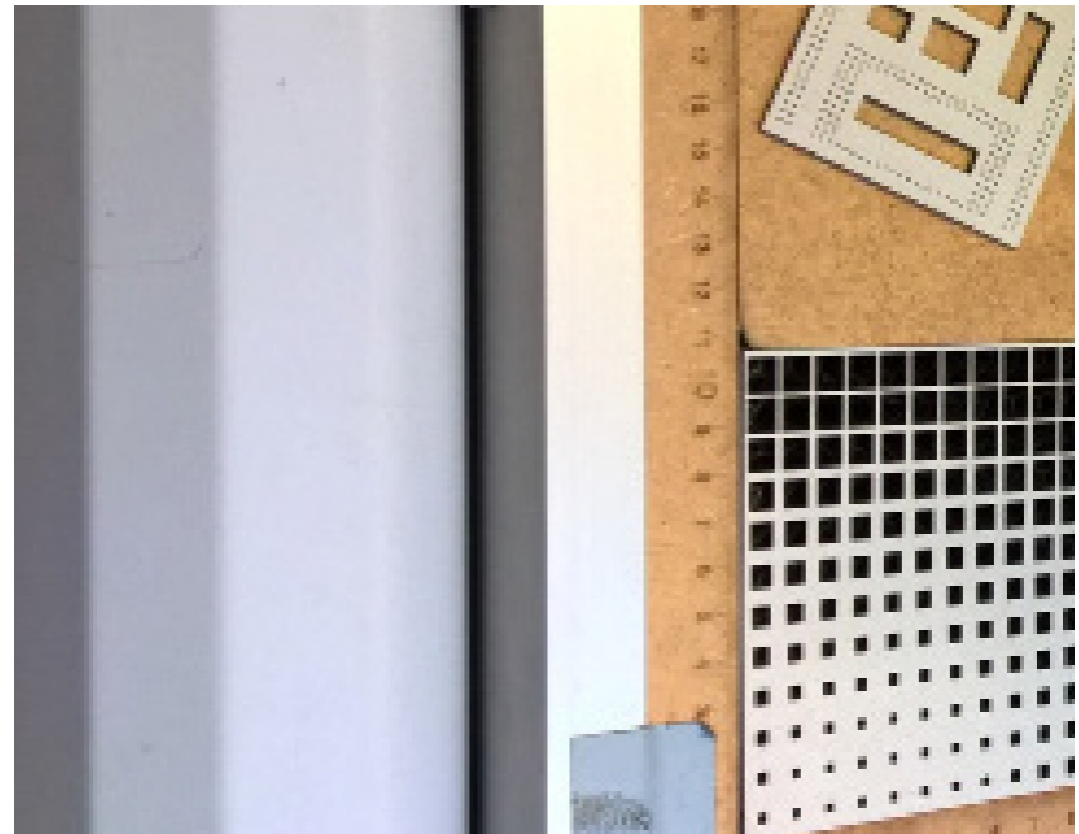

Department of Architecture Student Council



**FAKULTÄT
FÜR ARCHITEKTUR**

The student councils of the department of architecture represents all students of the bachelor and master courses.

As an independent association they support the interests of the students in the commissions and bodies of the department.

Furthermore, they help by general questions and organisational affairs for example events, celebrations and exhibitions.



fsarchkit
fachschafkunstgeschichteka

<https://fsarchi.com/>
<https://kg.ikb.kit.edu/3019.php>



Department of Architecture Central Services



**FAKULTÄT
FÜR ARCHITEKTUR**

Faculty Board

20.40 Rooms 135–138

Dean

Prof. Dirk Hebel

Deputy Chairperson

Prof. Dr. Jaoquin Medina Warmburg

Deputy Chairperson Research

Prof. Andreas Wagner

Deputy Chairperson Strategy

Prof. Simon Hartmann

Dean of Studies

Prof. Dr. Barbara Engel

Dean of Studies (Art History)

Prof. Dr. phil. Oliver Jehle

Managing Director

Dr.-Ing. Judith Reeh

Deanery

20.40, Room 135

Mon.-Tue., Thu.-Fri. 9:00 until 12:00 h

Phone: (0721) 608-42156

Fax: (0721) 608-46090

eMail: dekanat@arch.kit.edu

Dean's Assistance

Nina Dürr

Office for Student Affairs – Department

20.40, Room 139

Ute Hoffmann

Phone: (0721) 608-43879

ute.hofmann@kit.edu

Opening hours:

Mon., Tue. and Thu. 9:00 until 12:00 h

Department of Architecture Research



**FAKULTÄT
FÜR ARCHITEKTUR**

The subject fields follow a variety of very different research approaches—from a more theoretical basic research constantly developing new methods, models and technologies up to the concrete application of innovative methods and technologies in the planning and structural practice.

Building from Waste / FG Prof. Hebel (2019)
Pavillon for the BUGA (Bundesgartenschau Heilbronn / Federal Landscape Fair).
Design to Built - Student Project
with recycled material

<http://nb.ieb.kit.edu/>



The subject fields:

- Climate-compatible and Energy-efficient integrated Planning und Building
- Sustainable Materials and Resources
- Digital Methods for the Built Environment
- Transformation of City und Landscape
- Human Centered Design
- Architectural Criticism and Curatorial Practice
- Cultural Heritage and Historical Building Research

Tinyhouse - Karlsruhe

Project – Prof. Ludwig Wappner



Design and Build

arch.kit.edu

FAKULTÄT
FÜR ARCHITEKTUR



Sustainability



Projekt RoofKIT, Prof. Dirk Hebel und Prof. Andreas Wagner

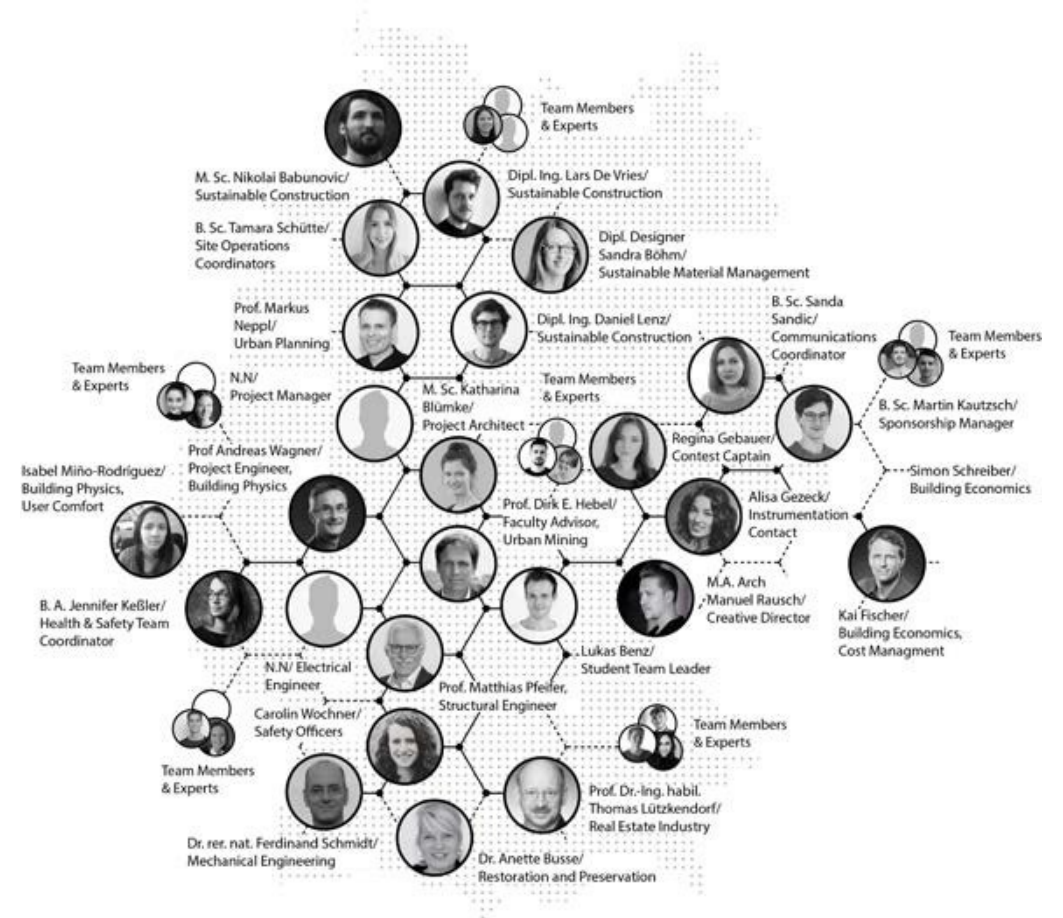

Sustainability

arch.kit.edu

**FAKULTÄT
FÜR ARCHITEKTUR**



Department of Architecture Research



**FAKULTÄT
FÜR ARCHITEKTUR**

The RoofKIT team of the KIT Department of Architecture has won the German premiere of the world's largest university-based Solar Decathlon competition in Wuppertal.

The students of the Karlsruhe Institute of Technology (KIT), led by Prof. Dirk E. Hebel and Prof. Andreas Wagner, scored the most points in all disciplines of the solar decathlon - and thus presented the most convincing concept for continuing to build our cities in a climate-friendly way.



Research

SAAI - Südwestdeutsches Archiv für Architektur und
Ingenieurbau



Biennale Venice 2018

Sleeping Beauty –
Reinventing Frei Otto's Multihalle/ Exhibition in Venice



Introduction Master Programme



General semester dates

- | | |
|--------------------------|-----------------------------------|
| 15.04.2024 | Start Lecture time |
| 01.-31.05.2024 | Registration for the exams |
| 27.07.2024 | End Lecture Time |
| 29.07.-16.08.2024 | Exam Period |



Department of Architecture Information Resources



**FAKULTÄT
FÜR ARCHITEKTUR**



Modulhandbuch Architektur Master 2021 (M.Sc.)

SPO 2021
Sommersemester 2021
Stand 23.03.2021

KIT-FAKULTÄT FÜR ARCHITEKTUR



The Module Handbook

can be downloaded from the department's website.

It contains detailed information to all modules and courses, as well as the study- and examination regulations of the department.

https://www.arch.kit.edu/english/masterstudiengang_architektur.php?tab=%5B5307%5D#tabpanel-5307

Department of Architecture Information Resources



**FAKULTÄT
FÜR ARCHITEKTUR**



The Semester Program

is available at the beginning of a new semester and can be downloaded as a pdf from the department's website.

It contains information on the range of courses, events, schedules, study schedules, important addresses, dates and far more.

Information of courses you can find in the online university calendar.

https://www.arch.kit.edu/img/WS2324_SemProg_EN_web.pdf

Master of Science - Study Structure SPO 2021

1. Sem	2. Sem	3. Sem	4. Sem
Building Design Project Building Design Project 12 CP	Urban Design Project Urban Design Project 12 CP	Design Project Design Project 12 CP	Master's Thesis 30 CP
Design Specialization 2CP	Design Specialization 2CP	Design Specialization 2 CP	
Integrated Building Technologies* 4CP	Urban and Landscape Planning* 4 CP	Elective Module* 4 CP	
Design, History, Art and Theory* 4 CP	Lecture Series** 4 CP	Interdisciplinary Qualifications* Key Qualifications 4 CP	
Elective Module* 4 CP	Elective Module* 4 CP	Seminar Week 2 CP	
Impromptu Designs 4 CP	Elective Module* 4 CP	Research Fields Research Seminar / Independent Student Research Project 4 CP Preparation Master's Thesis 2 CP	
30 CP	30 CP	30 CP	30 CP

* Placeholder for various modules

** Thematic lecture series on the main areas of study

• Programs (bachelor / master) are design/studio-focused.

• Master = 2 year program

• 10-12 design projects / studios each semester with max. 18 students

The design projects (topics) vary from semester to semester, but it is secured that there are always 3-4 design projects in urban design.

• mostly seminars (groups of max. 15-20 students), very little lectures on master-level.

• Master-thesis is a design project and the students have to develop their own project.

• No specialized masterprogram

The focus areas:

- Urban design
- Integrated Building Technologies
- Design Research
- Computational Design

Bachelor of Science - Study Structure

1. Sem	2. Sem	3. Sem	4. Sem	5. Sem	6. Sem
Studio Space 10 CP	Studio Structure 10 CP / OE	Studio Material 10 CP	Studio Context 10 CP	Studio Building or Urban Design 12 CP	Bachelor's Thesis 12 CP
Basics of Design Theory 4 CP	Basics of Building Construction 4 CP	Building Construction 4 CP	Basics of Urban Planning 4 CP	Sustainability 2 CP	Spezialization Bachelor's Thesis 2 CP
Artistic and Sculptural Design 4 CP	Static and Strength of Materials 4 CP	Structural Design 4 CP	Basics of Building Studies and Design 4 CP	Spezialization Studio 2 CP	Interdisciplinary Qualifications 6 CP
Building Materials Science 4 CP	Building Physics 4 CP / OE	Building Services 4 CP	Law for Architects and Construction Planning Law 4 CP	Construction Eco- nomics and Project Management 4 CP	Elective Module* 4 CP
Architectural Geometry 4 CP / OE	Integrative Digital Methods 4 CP	Explorative Digital Methods 4 CP	Communication of Architecture and Scientific Methodology 4 CP	Elective Module* 4 CP	Seminar Week 4 CP
Basics of Theory of Architecture 4 CP / OE	History of Architecture and Urban Planning 4 CP	History of Architecture and Urban Planning, Urban Development 4 CP	History of Architecture and Urban Planning, Building Survey 4 CP	Basics of Art History 2 CP	Basics of Art History 2 CP
30 CP	30 CP	30 CP	30 CP	30 CP	30 CP

Which courses are offered?

Please make sure to attend these events!

Architecture:

Monday, 08.04.2024, 9.30 am

Welcome and general information about the
summer semester
Presentation of the design topics
20.40 Fritz Haller lecture hall

Monday, 08.04.2024, 02:00 pm

Presentation of the elective courses "Seminar
bazaar"
11.40 Tulla Hall

Art History:

Tuesday, 09.04.2024, 09.30 am

Presentation of the courses, information on the
organization of studies, contact persons, dates,
election procedures, etc.
Lecture hall 9

During the presentation of the design projects Ms. Kern will explain the registration process for the courses!

Department of Architecture



**FAKULTÄT
FÜR ARCHITEKTUR**

How and when do I choose my courses?

.....

FAi-Erasmus- Office:
Building 20.40
R 139

Ms. Silke Marx

Email:
silke.marx@kit.edu

Phone:
+49 721 608-42155

You have to choose:

- Your master design projects

Tuesday, 09.04.2024 10.00 am: Start registration for master's drafts

Wednesday, 10.04.2024 10.00 am: End of registration for master's drafts

-> Link will be send in time

- Elective courses

Tuesday, 09.04.2024 10.00: Start of registration for seminars and seminar week

Wednesday, 10.04.2024 10.00: 1st draw for seminars and seminar week

Thursday, 11.04.2024 10.00: End of registration for seminars and seminar week

-> Link will be send in time

Until the 1st raffle, registration is only possible for a maximum of 3 events, thereafter unlimited. From the time of the 1st raffle on, vacant places will be raffled every 10 minutes. Please return any unwanted places in the system until closing date.

Online University Calendar

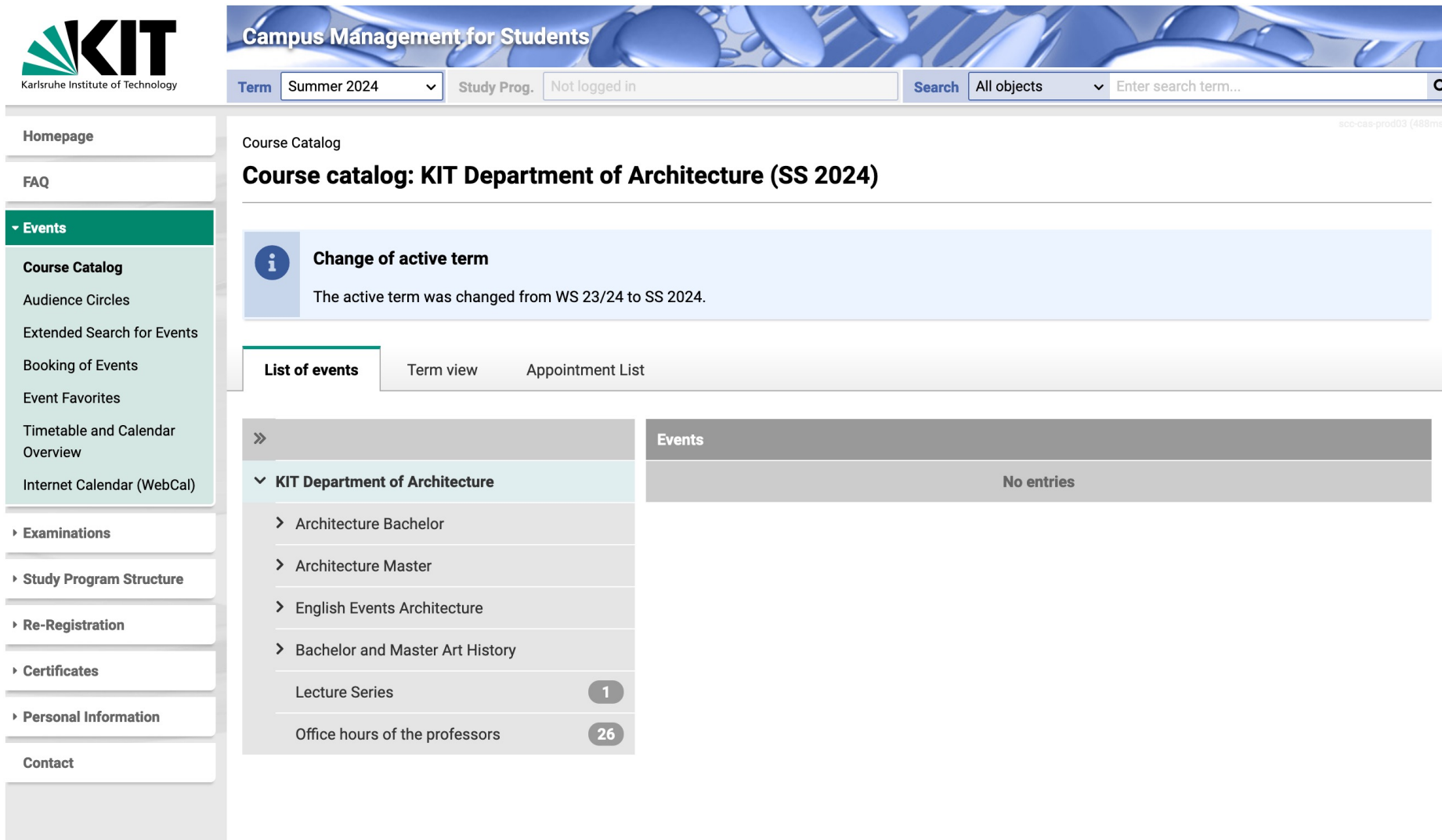

The screenshot shows the 'Campus Management for Students' interface. At the top, there is a navigation bar with 'Term' set to 'Summer 2024', 'Study Prog.' set to 'Not logged in', and a search bar. The main content area is titled 'Course Catalog' and 'Course catalog: KIT Department of Architecture (SS 2024)'. A notification banner states 'Change of active term' with the message 'The active term was changed from WS 23/24 to SS 2024.' Below this, there are tabs for 'List of events', 'Term view', and 'Appointment List'. The 'List of events' tab is active, showing a tree view of the department's offerings. The 'Events' column is currently empty, displaying 'No entries'. The left sidebar contains various navigation options such as 'Homepage', 'FAQ', 'Events', 'Examinations', and 'Personal Information'.

KIT
Karlsruhe Institute of Technology

Campus Management for Students

Term Summer 2024 Study Prog. Not logged in Search All objects Enter search term...

Course Catalog

Course catalog: KIT Department of Architecture (SS 2024)

Change of active term
The active term was changed from WS 23/24 to SS 2024.

List of events Term view Appointment List

	Events
>>	
▼ KIT Department of Architecture	No entries
> Architecture Bachelor	
> Architecture Master	
> English Events Architecture	
> Bachelor and Master Art History	
Lecture Series	1
Office hours of the professors	26

Department of Architecture



**FAKULTÄT
FÜR ARCHITEKTUR**

Where can I go, if I have problems with my courses?

First contact: If you have any problems with your courses during your stay - please contact Ms. Silke Marx.

FAi-Erasmusbüro
Building 20.40, R 139
Silke Marx
Phone: +49 721 608-42155
silke.marx@kit.edu

For general questions:

Office for Student Affairs - Department
Ute Hoffmann
Phone.: +49 721 608-43879
ute.hofmann@kit.edu

Department of Architecture



**FAKULTÄT
FÜR ARCHITEKTUR**

How do I get my Transcript of Records?

You can print out your Transcript of Records by yourself in our (online) “Studierendenportal“.

You will find a QR Code on the Transcript of Records.
This shows the verification of the document.

IMPORTANT

If you need your „Transcript of Records“ for a special deadline, please contact Ms. Silke Marx as soon as you know about it.

FAi-Erasmus- Office:
Building 20.40
R 139

Ms. Silke Marx
Email:
silke.marx@kit.edu

Telephone:
+49 721 608-42155

We wish you a good
study time
in Karlsruhe!

