

FAKULTÄT FÜR ARCHITEKTUR

GEBÄUDE **20.40** **BUILDING** 20.40
Erdgeschoss Groundfloor

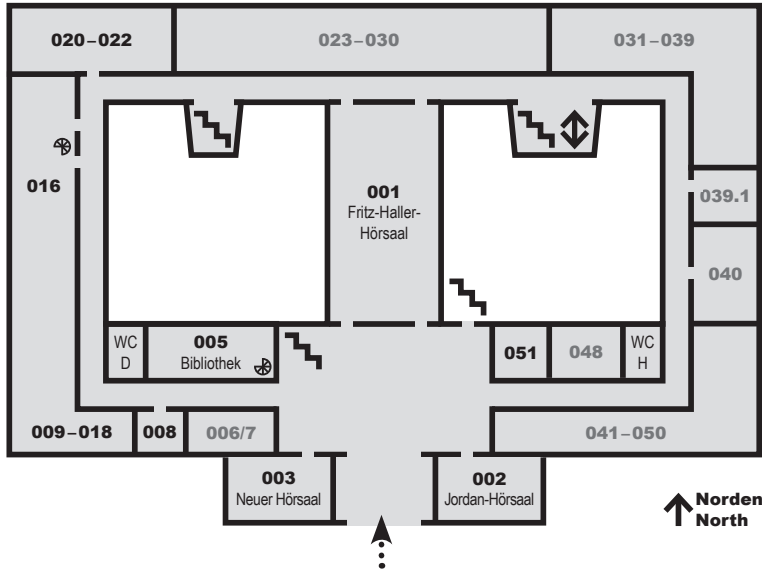

Stand: 24.08.2017

- | | |
|----------------------------------------------------------------------------------------------------------------------------------------------------------------------------------------------------------------------------------------------------------------------------------------------------------------------------------------------------------------------------------------------------------------------------------------------------------------------------------------------------------------------------------------------------------------------------------------------------------------------|----------------------------------------------------------------------------------------------------------------------------------------------------------------------------------------------------------------------------------------------------------------------------------------------------------------------------------------------------------------------------------------------------------------------------------------------------------------------------------------------------------------------------------|
| <p>001 FRITZ-HALLER-HÖRSAAL
Lecture Hall</p> <p>002 JORDAN-HÖRSAAL
Lecture Hall</p> <p>003 NEUER HÖRSAAL
Seminar Room</p> <p>005 Fakultätsbibliothek
(Zugang über Raum 106)
Faculty Library
(Access via Room 106)</p> <p>008 Fachschaft Kunstgeschichte
Student Council Art History</p> <p>009-018 BAUGESCHICHTE
Building History
Prof. Böker</p> <p>016 Bibliothek Baugeschichte
Library of Building History</p> <p>020-022 KUNSTGESCHICHTE
Art History
Prof. Jehle</p> | <p>FAKULTÄT BAU-, GEO- UND
UMWELTWISSENSCHAFTEN
Faculty of Civil Engineering</p> <p>006/7 Fachschaft Geodäsie
Student Council Geodesy</p> <p>023-030 Institut für Photogrammetrie
Intitute for Photogrammetry</p> <p>031-050 Geodätisches Institut
Geodetic Institute</p> <p>039.1 PC-Pool</p> <p>040 Haid Hörsaal
Haid Lecture Hall</p> <p>048 Sky Hörsaal
Sky Lecture Hall</p> <p>051 Hausmeister
Caretaker</p> |
|----------------------------------------------------------------------------------------------------------------------------------------------------------------------------------------------------------------------------------------------------------------------------------------------------------------------------------------------------------------------------------------------------------------------------------------------------------------------------------------------------------------------------------------------------------------------------------------------------------------------|----------------------------------------------------------------------------------------------------------------------------------------------------------------------------------------------------------------------------------------------------------------------------------------------------------------------------------------------------------------------------------------------------------------------------------------------------------------------------------------------------------------------------------|

GEBÄUDE 20.40

1. Obergeschoss

BUILDING 20.40

First Floor

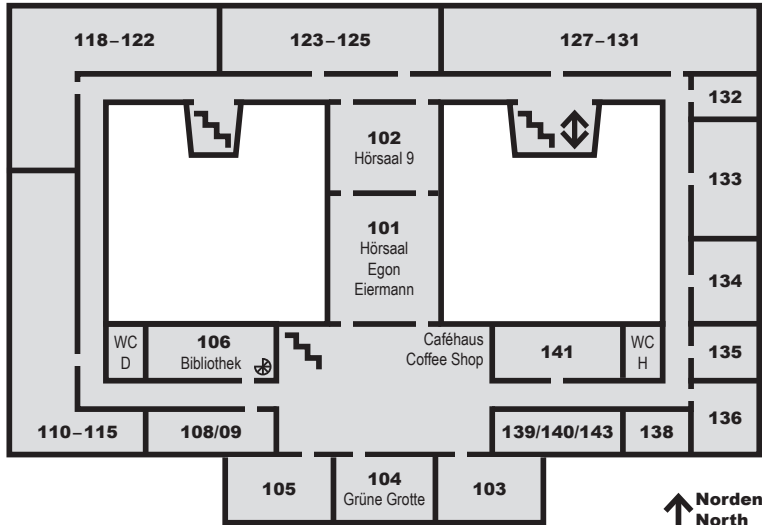

Stand: 24.08.2017

- | | | | |
|----------------------|------------------------------------------------------------------------------------|----------------------|---------------------------------------------------------------------------------------------------------|
| 101 | EGON-EIERMANN-HÖRSAAL
Lecture Hall | 127 | MASTERSTUDIENGANG
ALTBAUINSTANDESETZUNG
Master Programme
Building Restoration
Prof. Pfeifer |
| 102 | HÖRSAAL 9
Lecture Hall | 130 | TRAGKONSTRUKTIONEN
Structural Design
Prof. Pfeifer |
| 103 | Arbeitsaal (Bachelor)
Student Studio (Bachelor) | 132 | BAUTECHNOLOGIE
Building Technology
Prof. R. Wagner |
| 104 | Seminarraum Grüne Grotte
Seminar Room | 133/134 | Arbeitsäle (Master)
Student Studios (Master) |
| 105 | Arbeitsaal (Bachelor)
Student Studio (Bachelor) | 135 | Dekanatssekretariat
Dean's Secretary and
Office of Study Affairs |
| 106 | Fakultätsbibliothek
Faculty Library | 136 | Fakultätssitzungssaal
Faculty-Meeting Room |
| 108/09 | ARCHITEKTUR UND MOBILIAR
Interiors and Furniture Design
AkadOR Dill | 138 | Dekan und
Geschäftsführung
Dean and Managing Director |
| 110-115 | GEBÄUDELEHRE
Building Design
Prof. Morger | 139 | Studienberatung
Study Counselling |
| 113 | Seminarraum Gebäudelehre
Seminar Room Building Design | 140 | Öffentlichkeitsarbeit
Public Relations |
| 118-122 | BUILDING LIFECYCLE
MANAGEMENT
Building Lifecycle Management
Prof. v. Both | 141 | MATERIALBIBLIOTHEK
Material Collection |
| 123-125 | KUNSTGESCHICHTE
Art History
Prof. Jehle / Prof. Schulze | | |

GEBÄUDE 20.40

2. Obergeschoss

BUILDING 20.40

Second Floor

Stand: 24.08.2017



- | | |
|----------------------------------------------------------------------------------|---------------------------------------------------------------------------------------------------|
| 201/203 ...Arbeitsäle (Diplom/Master)
Student Studios (Diploma/Master) | 234-239 ..BAUPHYSIK UND
TECHNISCHER AUSBAU
Building Science
Prof. A. Wagner |
| 202Fachschaft Architektur
Student Council Architecture | 240-250 ..BAUKONSTRUKTION
Building Construction
Prof. Wappner |
| 204Zeichensaal
Drawing Room |GRUNDLAGEN DER
BAUKONSTRUKTION
Fundamentals of Building
Construction
AkadOR Haug |
| 206/208 ...Arbeitsäle (Diplom/Master)
Student Studios (Diploma/Master) |KONSTRUKTIVE
ENTWURFSMETHODIK
Building Construction Methodology
Prof. Vallebuona |
| 207BLM Labor
BLM Laboratory
Prof. v. Both | 254-258 ..ARCHITEKTURTHEORIE
Theory of Architecture
Prof. Vrachliotis |
| 213Fakultätsbibliothek
Faculty Library | 257-260 ..ARCHITEKTUR-
KOMMUNIKATION
Communication of Architecture
Prof. Rambow |
| 210EKUT-Seminarraum
Seminar Room | 262PlotPool |
| 215DARSTELLENDGEOMETRIE
Descriptive Geometry
Dipl.-Ing. Beyer | |
| 216-220 ..RAUM UND ENTWERFEN
Spatial Design
Prof. Frohn | |
| 221-230 ..BAUPLANUNG
Architectural Design
Prof. i.V. Krawczyk | |
| 231-233 ..BILDENDE KUNST
Visual Arts
Prof. Craig | |

GEBÄUDE 20.40

Untergeschoss

BUILDING 20.40

Basement

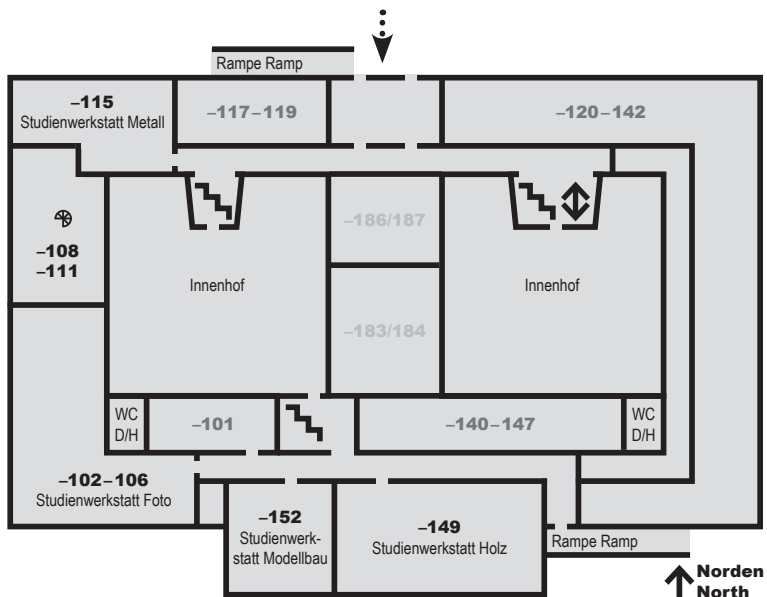

Stand: 24.08.2017

- 102.....Studienwerkstatt Foto
Study Workshop Photography
Hr. Seeland / Hr. Engel
- 108-111 Bibliothek Baugeschichte
(Zugang über Raum 016)
Library of Building History
(Access via Room 016)
- 115.....Studienwerkstatt Metall
Study Workshop Metal
Hr. Heil
- 149.....Studienwerkstatt Holz
Study Workshop Wood
Fr. Knipper / Hr. Sander
- 152.....Studienwerkstatt Modellbau
Study Workshop Model
Hr. Neubig

FAKULTÄT BAU-, GEO- UND
UMWELTWISSENSCHAFTEN
Faculty of Civil Engineering

-117-145 Geodätisches Institut
Geodetic Institute

FAKULTÄT FÜR ARCHITEKTUR

GEBÄUDE 11.40 BUILDING 11.40 Erdgeschoss Groundfloor

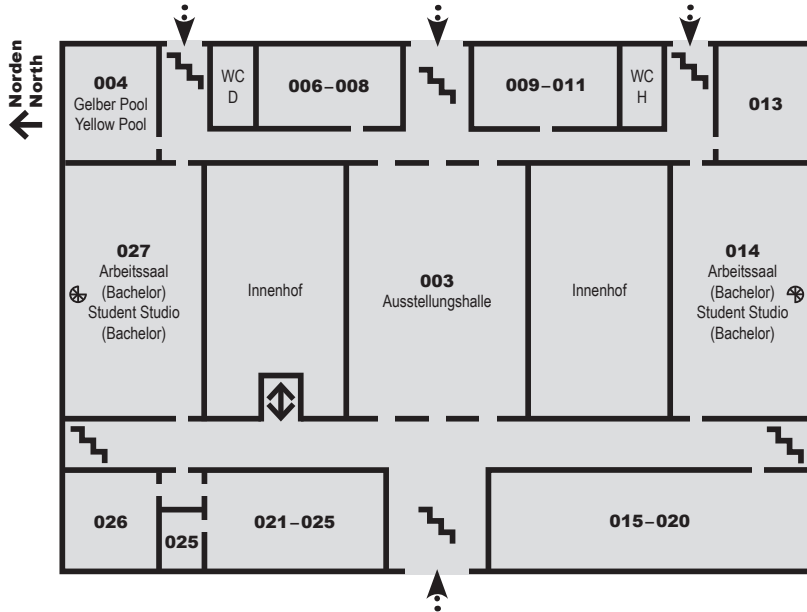

Stand: 24.08.2017

- | | |
|---------------------------------------------------------------------------------------------------|---------------------------------------------------------------------------------------------------|
| 003Ausstellungshalle
Exhibition Hall | 015-020 ..STADTQUARTIERSPLANUNG
Urban Housing and Development
Prof. Neppel |
| 004Gelber Pool
Yellow Pool | 018ARCH.LAB
Dr. Jäkel |
| 008Hausmeister
Caretaker | 021-025 ..NACHHALTIGES BAUEN
Sustainable Building Design
Prof. Hebel |
| 009-011 ...archIT
IT-Service
Hr. Besser, Hr. Gonzalez | 026Seminarraum
Seminar Room |
| 013Seminarraum
Seminar Room | 027Arbeitsaal (Bachelor)
Untere Ebene
Student Studio (Bachelor)
Lower Level |
| 014Arbeitsaal (Bachelor)
Untere Ebene
Student Studio (Bachelor)
Lower Level | |

GEBÄUDE 11.40

Galerie

BUILDING 11.40

Gallery

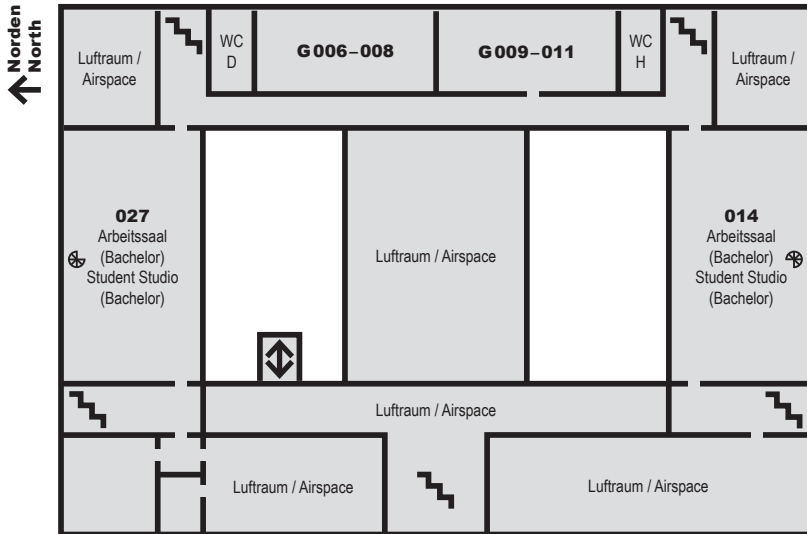

Stand: 24.08.2017

G006-008 INTERNATIONALER STÄDTEBAU

(Zugang über Raum 109)
International Urban Design
(Access via Room 109)
Prof. Engel

G009-111 REGIONALPLANUNG UND BAUEN IM LÄNDLICHEN RAUM

Regional Planning and Building
in Rural Areas
Prof. Gothe

014..... Arbeitssaal (Bachelor)
Obere Ebene
Student Studio (Bachelor)
Upper Level

027 Arbeitssaal (Bachelor)
Obere Ebene
Student Studio (Bachelor)
Upper Level

GEBÄUDE 11.40

1. Obergeschoss

BUILDING 11.40

First Floor

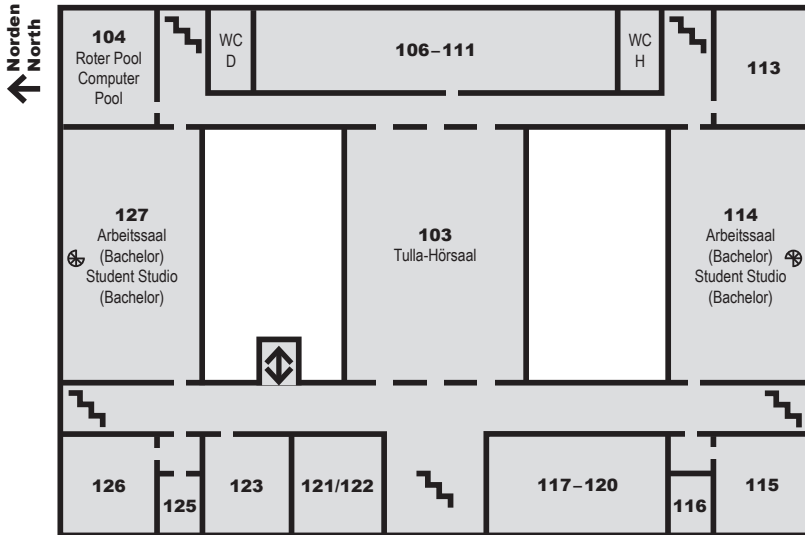

Stand: 24.08.2017

- | | | | |
|----------------------|-----------------------------------------------------------------------------------|----------------------|-----------------------------------------------------------------------------------|
| 103 | TULLA-HÖRSAAL
Lecture Hall | 115-126 | LANDSCHAFTSARCHITEKTUR
Landscape Architecture
Prof. Bava |
| 104 | Roter Pool
Red Pool | 115 | Seminarraum
Seminar Room |
| 106-111 | INTERNATIONALER STÄDTEBAU
International Urban Design
Prof. Engel | 123 | Bibliothek Landschaftsarchitektur
Library Landscape Architecture |
| 109 | Sekretariat
Secretariat | 125 | Sekretariat
Secretariat |
| 113 | Künstlicher Himmel
Artificial Sky | 127 | Arbeitsaal (Bachelor)
Untere Ebene
Student Studio (Bachelor)
Lower Level |
| 114 | Arbeitsaal (Bachelor)
Untere Ebene
Student Studio (Bachelor)
Lower Level | | |

GEBÄUDE **11.40**
Souterrain

BUILDING 11.40
Basement

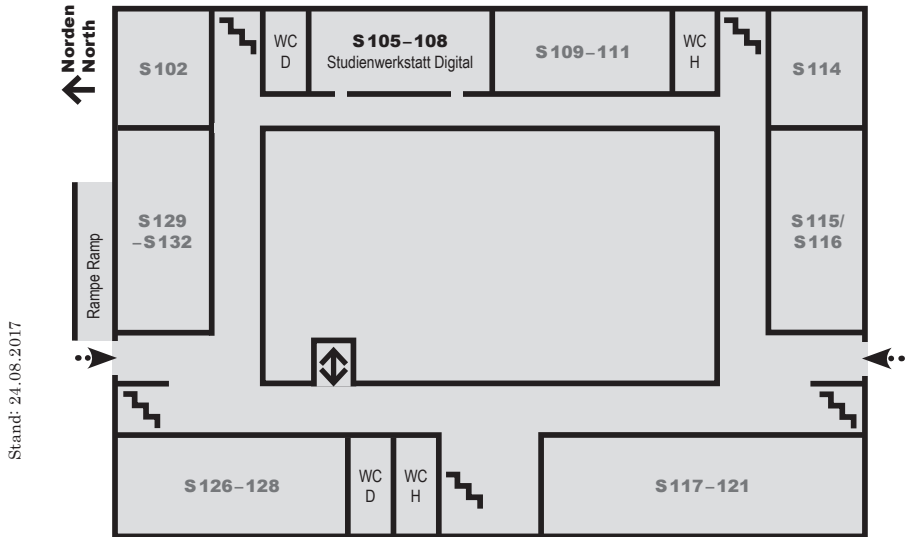

S 105-108 Studienwerkstatt Digital / Lasercutter
Study Workshop Digital
Hr. Abraham